



Great Swamp Bonsai Society

Next meeting: **SATURDAY, Nov 13th**

Noon - 4:00 PM – Jin Implants!

November 2021 Newsletter

November Meeting: Saturday, November 13th, noon–4:00 PM

This month's meeting will be held at the home of **Fred and Doris Aufschläger in Bernardsville, NJ**. As always, feel free to bring a folding chair, and food or beverages as you wish—and a tree, if you have something to show off, or something you'd like help with. The official topic is **Jin Implants (inserting deadwood where none currently exists)**, led by club member **John Michalski**, so please feel free to bring along any examples of bonsai that make use of natural or “artistically enhanced” deadwood from your own collection.

The address is: **17 Lakeview Drive, Bernardsville NJ 07924**.

Hope to see you all there!



Left: a dwarf Alberta spruce in its current condition.

Right: the same tree with potential placement(s) of “new” deadwood.

Last month's meeting: [Saturday, October 16th](#), at the home of Mark and Sheila Schmuck.

Last month's meeting was hosted at the home of **Mark and Sheila Schmuck** in Rockaway, NJ. The predicted rainy weather held off until the moment the meeting concluded, with good food, drinks, and excellent company, set in Mark and Sheila's spectacular garden (see below). The topic, led by **Mark**, was the design and artistic principles that distinguish various bonsai forms (formal upright, informal upright, semi-cascade, etc.). As usual, club members brought along several examples to help illustrate the presentation, and provide material for conversation and advice. Club member **Izzy Gurler** brought another selection of plants in need of new homes, which were gratefully accepted by those in attendance.

Thanks once again to Mark and Sheila for hosting, and to all who participated. We look forward to seeing you next time!

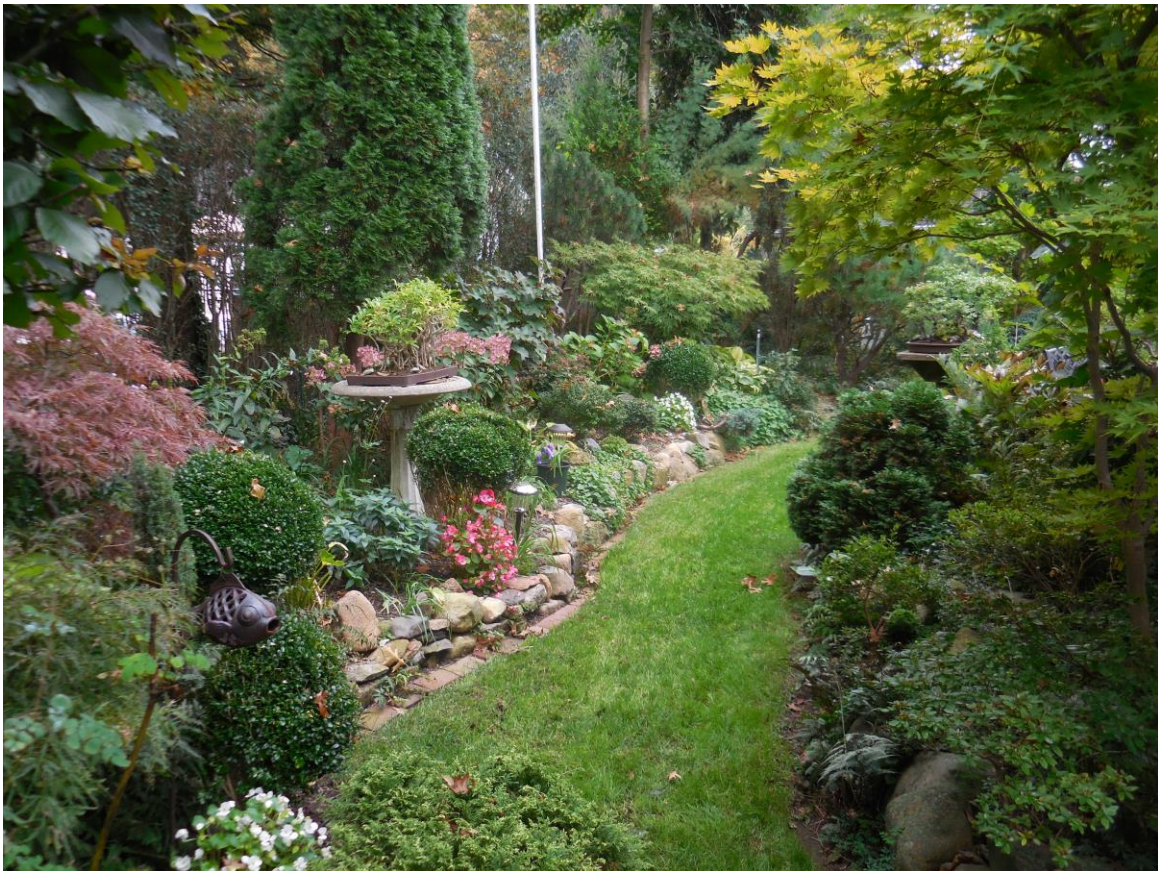

Photos from October Meeting



The Life Story of a Dwarf Alberta Spruce

I am forever encouraging club members to take photos of every tree in their collection, at least once a year, preferably with a neutral background, and preferably at the same time every year. It's also a good idea to take "before and after" photos whenever you undertake pruning or design work. You'd be amazed at how much development occurs in trees that you've come to take for granted!

The photo series below is of a dwarf Alberta spruce that was given to me very shortly after I began working with bonsai back in the 1990s. The tree started out as a supermarket "Christmas tree" in a planter that my sister-in-law had no further use for. I was very proud of my initial design work, though I can now see how rudimentary my skills were at the time. This is part of the fun of keeping (and reviewing) those "baby pictures," as you develop as an artist. Your bonsai are improving, and so is your skill set. [JM]



1996



1998



2002



2007



2012



2013



2018*

* 2018 was the year that a deer got tangled in some guywires and dragged the tree halfway across my yard before breaking free.

Plant Care Tips for November

During November deciduous and evergreen trees can remain out until about the last week of the month. Prepare trees for their winter setting, whether it be a cold frame or whatever type of winter protection you may have. Prior to setting them in their winter quarters, check for insects and spray and remove all dead leaves and branches. Thinking ahead, write down and plan what you need to do for spring and choose which trees you will work on first. Tropicals should already be indoors and you can continue to water, feed, repot and prune them all through the winter. If they are in a heated dry atmosphere, mist frequently. [DY]

Dues to be Reinstated Shortly

The GSBS has been arranging for several guest presentations, including meetings to be held at bonsai nurseries and led by professional artists and growers. As such, we are preparing to reintroduce club dues, the price and schedule to be determined. We do not anticipate any great changes from what we have done in the past. Stay tuned.

Repeat: GSBS Facebook Page / GSBS YouTube Channel

A reminder that our club **Facebook Page** is a wonderful venue for anyone in the group to post photos, ask questions, or chime in with ideas and opinions about other people's work and accomplishments. To contribute to the discussion, all you have to do is go to the page and request to join the group—once your request has been accepted, you will be able to post photos, videos, and comments.

We have also established a Great Swamp Bonsai Society **YouTube Channel**, which at the moment features only a few amateur video clips by yours truly (John Michalski), expounding or demonstrating simple maintenance techniques for different species used in bonsai. If you have something you'd like to upload, get in touch with me at huonia@aol.com. Thanks!

Repeat: GSBS Sales Table – “Virtual” Sales Table

We will continue with our recent addition of a “sales table” for any bonsai-related articles that club members wish to offer for sale at our regular meetings. You simply bring your wares and post the prices with them.

In the meantime, feel free to post announcements on our club **Facebook Page** if you have something to sell, or something you are seeking. **(Non-commercial sales only, please. This is not intended as advertising space for full-time professionals.)** This is a good way for members to move along those items they no longer wish to keep, while offering same to other people who might cherish them! So please feel free!

Save Your Discarded Copper Bonsai Wire

Please remember to save and bring in those wire clippings. **It helps if you cut your wire into short (3-6 inch) lengths, as it packs more easily for transport and sale.** About once a year we bring them to a scrap metal dealer and swap them for cash. It's usually about enough to equal one or two paid memberships, so it really does help keep the GSBS afloat.

Keep those Topic Suggestions Coming!

A reminder to feel free to send your ideas and topic suggestions to any of the Board Members listed on the last page of this newsletter. GSBS is always looking for new and interesting topics that will appeal to the various educational needs of our diverse membership. The club exists for you, so don't be shy with your recommendations.

We especially welcome volunteers who wish to plan and lead presentations and workshops, so that the club may benefit from the wide array of experience contained within our membership.

Calendar of Events for 2021-2022

A return date to our original meeting room at the Frelinghuysen Arboretum is still uncertain. Please keep venue and topic ideas coming—we are cheerfully open to any and all suggestions!

All meetings held on Saturdays, noon to 4:00 PM, with rain date the following Sunday. **WATCH YOUR EMAIL FOR UPDATES.**

November 13th: Jin Implants—Adding dead limbs where no limbs exist. Led by John Michalski, hosted by Fred and Doris Aufschläger at their home in Bernardsville, NJ.

December: No Meeting Scheduled.

January & March: Stay Tuned! We are working on **indoor meetings** to be held at the **Rosade Bonsai Studio** in New Hope, PA, the **Allshapes Bonsai Nursery** in Ringoes, NJ.

February: Presentation by guest artist **Sergio Cuan**, demonstrating his technique of **thread-grafting on Maples. Location to be determined.**

GSBS Contact Information:

President: John Michalski
huonia@aol.com

Phone: 973-829-0094
223 Mt. Kemble Avenue
Morristown, NJ 07960

Past President: Diego E Pablos
neyamadoribonsai@gmail.com
Phone: 973.224.8139

Vice President: Mark Sanders dealmakr@att.net

Secretary: Mark Schmuck lofty235@optonline.net

Treasurer: Rick Myers spruce80@verizon.net
80 Kenvil Ave
Succasunna N J
07876

Newsletter: John Michalski huonia@aol.com

Club Information

Location:

The Frelinghuysen Arboretum
353 East Hanover Ave,
Morristown, NJ 07962

Date:

Usually the second Tuesday of each
Month, (check our website for
special dates and locations)

Time: 6:30 – 9:30 pm

**Remember to check our website
(<http://www.arboretumfriends.org/gsbonsai/index.htm>) for
special events, dates, updates
and latest information.**

Great Swamp Bonsai Society

c/o John Michalski
223 Mount Kemble Ave., Morristown, NJ 07960

DUES SUSPENDED UNTIL FURTHER NOTICE

Great Swamp Bonsai Society Membership Registration:

Send to:

GSBS c/o Rick Myers **New** **Renewal**
80 Kenvil Avenue
Succasunna, NJ 07876. **Individual (\$ N/A)** **Family (\$ N/A)**

Name(s): _____ **Email:** _____

Address: _____ **Phone:** (_____) _____

If Family Membership, please list other members:
